

Part Number	<b>TC50A</b>	Open-Close Angle of Handle	190°
Body Material	SS400	Mounting Bolt	M6
Surface Treatment	Bright Chromate Plating	Fixing Pitch	45 × 32
		Suppress Pressure(N)	1960
Unit Price Qty. 1-9	28.72	Tare(g)	540
		Stroke(mm)	30

### TC50A

Old

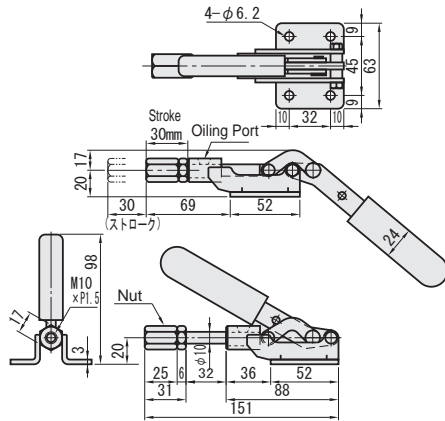

Part Number	<b>TC02SM</b>	Open-Close Angle of Handle	150°
Body Material	SS400	Mounting Bolt	M6
Surface Treatment	Bright Chromate Plating	Fixing Pitch	34 × 40
		Suppress Pressure(N)	1960
Unit Price Qty. 1-9	47.81	Tare(g)	370
		Oilless Bushing	LFZB12-12 2個
		Stroke(mm)	30

### TC02SM (Stroke Smooth Type)

Old

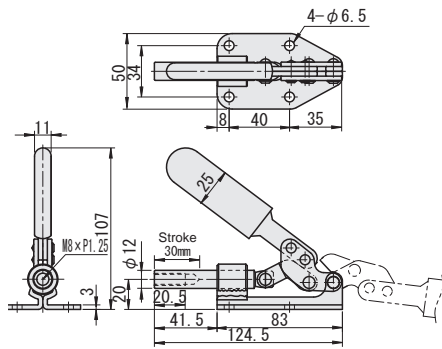

ⓘ The bushing has no oiling port.

Part Number	<b>MC07-6</b>	Open-Close Angle of Handle	190°
Body Material	SS400	Mounting Bolt	M6
Surface Treatment	<b>Trivalent Chromate</b>	Fixing Pitch	45 × 32
		Suppress Pressure(N)	1960
Unit Price Qty. 1-19	23.10	Tare(g)	390
		Stroke(mm)	30

### MC07-6

New

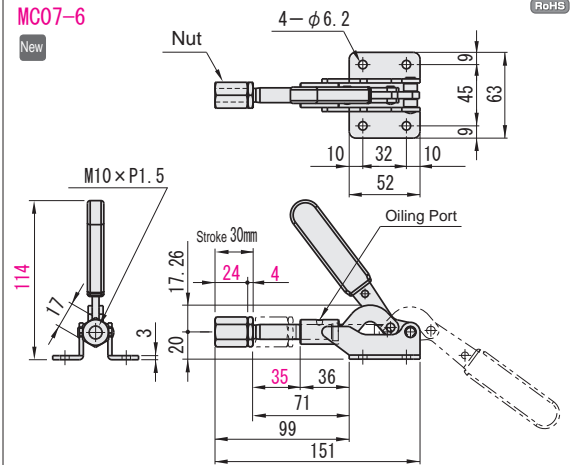

Part Number	<b>MC08-1</b>	Open-Close Angle of Handle	140°
Body Material	SS400	Mounting Bolt	M6
Surface Treatment	<b>Trivalent Chromate</b>	Fixing Pitch	34 × 40
		Suppress Pressure(N)	1960
Unit Price Qty. 1-19	38.35	Tare(g)	380
		Oilless Bushing	LFZB12-20 1個
		Stroke(mm)	30

### MC08-1 (Stroke Smooth Type)

New

