

Part Number	<b>TC38BLK</b>	Open-Close Angle of Arm	80°
		Open-Close Angle of Handle	80°
Body Material	SS400	Mounting Bolt	M10
Surface Treatment	Bright Chromate Plating	Fixing Pitch	30
Accessory	Stainless Steel Bolt	Suppress Pressure(N)	2744
Unit Price Qty. 1-9	27. 27	Tare(g)	460

**TC38BLK (Straight Base)**

Old

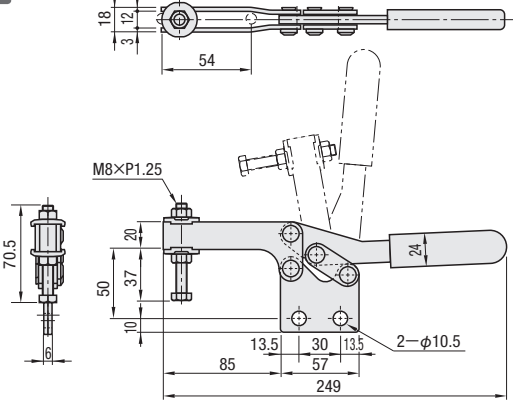

Part Number	<b>MC01-9S</b>	Open-Close Angle of Arm	79°
		Open-Close Angle of Handle	86°
Body Material	SS400	Mounting Bolt	M10
Surface Treatment	Trivalent Chromate	Fixing Pitch	30
Accessory	Stainless Steel Bolt	Suppress Pressure(N)	2744
Unit Price Qty. 1-19	21. 82	Tare(g)	435

**MC01-9S**

New

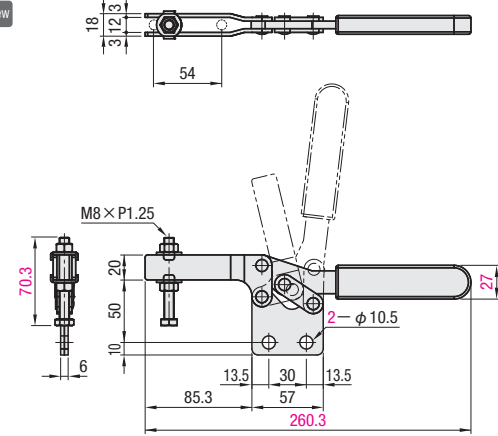

**Push-pull Combined Type**

Part Number	<b>F M50M</b>	<b>S F M50M</b>	Part Number	<b>F M150M</b>	<b>S F M150M</b>	Part Number	<b>FM250M</b>
Body Material	SS400	SUS304	Body Material	SS400	SUS304	Body Material	SS400
Surface Treatment	Bright Chromate Plating	-	Surface Treatment	Bright Chromate Plating	-	Surface Treatment	Bright Chromate Plating
Unit Price Qty. 1-9	25. 99	68. 19	Unit Price Qty. 1-9	35. 30	95. 46	Unit Price Qty. 1-9	63. 86
Open-Close Angle of Handle	180°	-	Open-Close Angle of Handle	180°	-	Open-Close Angle of Handle	180°
Stroke(mm)	19	-	Stroke(mm)	38. 1	-	Stroke(mm)	66. 7
Suppress Pressure(N)	900	-	Suppress Pressure(N)	1470	-	Suppress Pressure(N)	3138
Tare(g)	110	-	Tare(g)	260	-	Tare(g)	780

**FM50M**  
**SFM50M (Stainless Steel)**

RoHS

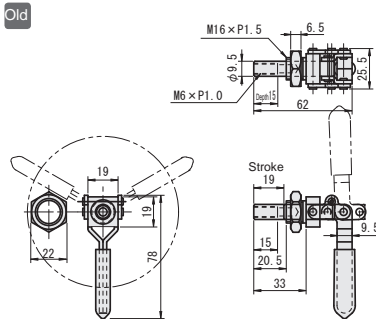

**FM150M**  
**SFM150M (Stainless Steel)**

RoHS

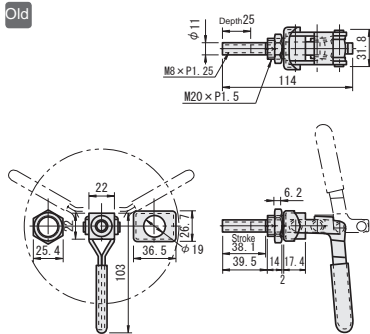

**FM250M**

Old

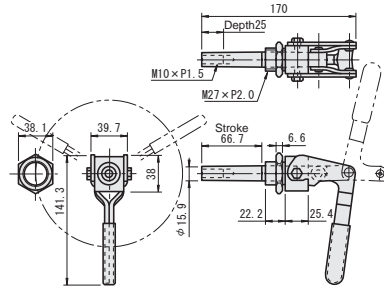

Part Number	<b>MC02-1</b>	<b>MC02-S1</b>	Part Number	<b>MC02-2</b>	<b>MC02-S2</b>	Part Number	<b>MC02-3</b>
Body Material	SS400	SUS304	Body Material	SS400	SUS304	Body Material	SS400
Surface Treatment	Trivalent Chromate	-	Surface Treatment	Trivalent Chromate	-	Surface Treatment	Trivalent Chromate
Unit Price Qty. 1-19	20. 86	54. 55	Unit Price Qty. 1-19	28. 24	76. 37	Unit Price Qty. 1-19	51. 18
Open-Close Angle of Handle	180°	-	Open-Close Angle of Handle	180°	-	Open-Close Angle of Handle	180°
Stroke(mm)	20. 34	-	Stroke(mm)	38. 9	-	Stroke(mm)	66. 7
Suppress Pressure(N)	900	-	Suppress Pressure(N)	1470	-	Suppress Pressure(N)	3138
Tare(g)	120	-	Tare(g)	280	-	Tare(g)	750

**MC02-1**  
**MC02-S1 (Stainless Steel)**

RoHS

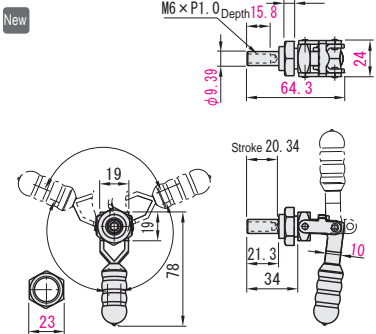

**MC02-2**  
**MC02-S2 (Stainless Steel)**

RoHS

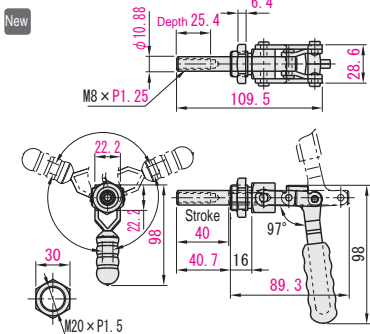

**MC02-3**

New

