

Equivalent to
HPM1
SKD61
S45C

SPRUE BUSHINGS

FIXED SIZE —BOLT FIXING TYPE / FLANGED TYPE—

Price Reduction
Up to 40%



Printed in Red

Bolt Fixing Type



TYPE	Material	Hardness
SBBP-B	Equivalent to HPM1	37~43HRC
SBBK-B	SKD61	48~52HRC
SJAC-B	S45C	—

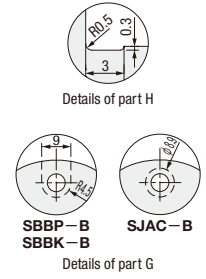
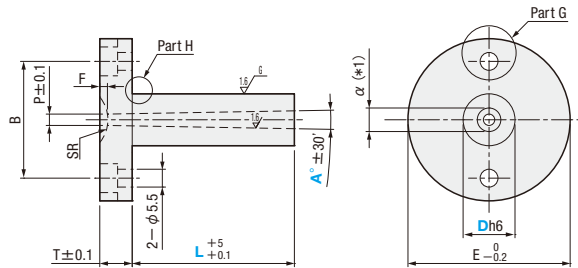

CB5-12(2pcs.)

Flanged Type



TYPE	Material	Hardness
SJBC-B	S45C	—

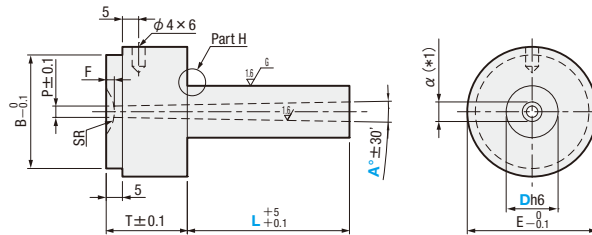

T	E	B	F	SR	P	Part Number		L	A°				
						Type	D						
10	40	30	3	11	3.5	(Equivalent to HPM1)	SBBP-B	10	40	2			
									60	2			
								13	40	2	3		
									80	2	3		
								16	80	2			
	35	25	2.5					(SKD61)	SBBK-B	10	40	2	
											60	2	
										13	40	2	3
											80	2	3
50	36				(S45C)	SJAC-B	13	100	2	3			
							16	100	2	3			
30	40	35	3			(S45C)	SJBC-B	13	100	2	3		

* 1 (Calculation of α value) $\alpha = P + 2(L + T - F) \tan \frac{A}{2}$

Please adjust the length before using.



Order

Part Number — L — A
SBBK-B13 — 40 — A2



Delivery

Printed in Red
SGP Stock