

DOWEL PINS



Printed in Red

The quantity discount rate is also applicable to alteration cost. All price & lead time are to be quoted.

Dimension ℓ_1 and ℓ_2 are reference values. They may sometimes become greater depending on the results of grinding of outer diameter.

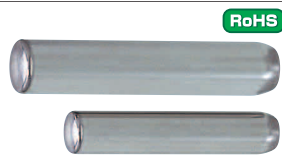

MS(Straight type)

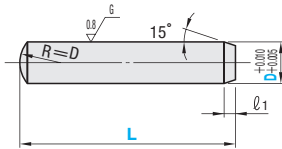

M SUJ2
H 58HRC ~

MSV(High precision type)

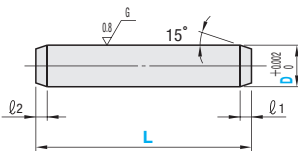

M SUJ2
H 58HRC ~

MSTP(Precision type with tapping)

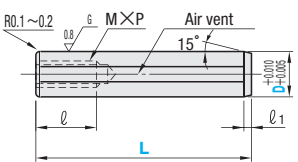

If L is 10 with a D5 and 6, the pilot hole may go through.

M SUJ2
H 58HRC ~

MST(p6 type with tapping)

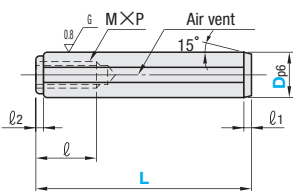

If L is 10 with a D5 and 6, the pilot hole may go through. (Groove to distinguish)

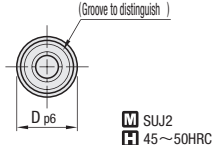

M SUJ2
H 45~50HRC

ℓ_1	Catalog No. Type	D	L	U/Price			
				Qty1~299	300~499	500~1999	2000~4000
0.4	1	6 8 10					
0.6							
1.0	2	6 8 10 15 20					
1.5	3	6 8 10 15 20 25 30 35 40					Quotation
2.0	5	8 10 15 20 25 30 35 40 45 50					Quotation
2.5	8	8 10 15 20 25 30 35 40 45 50 55 60					Quotation
3.0	12	15 20 25 30 35 40 45 50 55 60 65 70 80					Quotation
3.5	12	20 25 30 35 40 45 50 55 60 70 80					Quotation

ℓ_1	ℓ_2	Catalog No. Type	D	L	U/Price			
					Qty1~299	300~499	500~1999	2000~4000
1.0	0.2	2	6 8 10					
1.5	0.5							
2.0	0.5	3	8 10 15 20 25 30				Quotation	
								2.5
3.0	0.5	4	10 15 20 25 30				Quotation	
								10

The high precision dowel pins are measured in a thermostatic chamber.

ℓ_1	ℓ_2	Catalog No. Type	D	L	U/Price			
					Qty1~299	300~499	500~1999	2000~4000
1.5	0.3	*6	5	10 15 20 25 30				
2.0								
2.5	0.5	*8	6	10 15 25 35 40 50			Quotation	
				8				
3.0	1.0	*10	10	15 20 25 30 35 40 45 50 60 70 80			Quotation	
				12				
3.0	1.25	*15	13	20 30 40 50 60 70 80			Quotation	
				16				

* $\ell_2=6$ is a reference value when D = 5. * Only when D = 6 and L = 10, $\ell_2=6$.

ℓ_1	ℓ_2	Catalog No. Type	D	L	D_{p6}	U/Price			
						Qty1~299	300~499	500~1999	2000~4000
1.5	0.5	*6	5	10 15 20 25 30	+0.020				
2.0									
2.5	0.7	*8	6	10 15 25 35 40 50	+0.024		Quotation		
				8					
3.0	1.0	*10	10	15 20 25 30 35 40 45 50 60 70 80	+0.015		Quotation		
				12					
3.0	1.25	*15	13	20 30 40 50 60 70 80	+0.029		Quotation		
				16					
3.0	1.5	*18	20	40 50 60 70 80	+0.035		Quotation		
				20					

* $\ell_2=6$ is a reference value when D = 5. * Only when D = 6 and L = 10, $\ell_2=6$.

MSTM(m6 type with tapping)

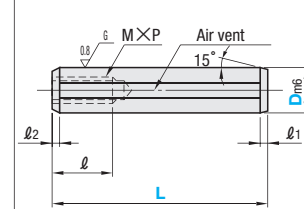

If L is 10 with a D5 and 6, the pilot hole may go through.

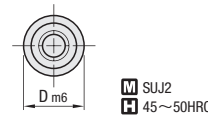

M SUJ2
H 45~50HRC

MTT(Tapered type with tapping)

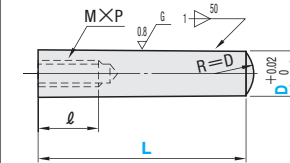

M SK4
H 45~50HRC

MSSH(h7 straight type)

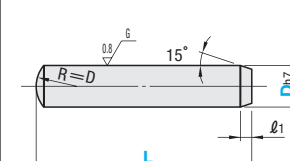

M SUJ2
H 58HRC ~

MSTH(h7 type with tapping)

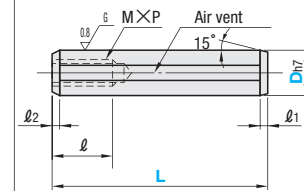

If L is 10 with a D5 and 6, the pilot hole may go through.

M SUJ2
H 45~50HRC

Dimension ℓ_1 and ℓ_2 are reference values. They may sometimes become greater depending on the results of grinding of outer diameter.

ℓ_1	ℓ_2	Catalog No. Type	D	L	U/Price			
					Qty1~299	300~499	500~1999	2000~4000
1.5	0.3	*6	5	10 15 20 25 30				
				6				
2.0	0.5	*8	6	10 15 25 35 40 50			Quotation	
				8				
2.5	1.0	*10	10	15 20 25 30 35 40 45 50 60 70 80			Quotation	
				12				
3.0	1.5	*15	13	20 30 40 50 60 70 80			Quotation	
				16				
3.0	1.5	*18	20	40 50 60 70 80			Quotation	
				20				

* $\ell_2=6$ is a reference value when D = 5. * Only when D = 6 and L = 10, $\ell_2=6$.

MXP	ℓ	Catalog No. Type	D	L	U/Price			
					Qty1~299	300~499	500~1999	2000~4000
M5x0.8	9	8	30	40			Quotation	
M6x1.0	10							
M8x1.25	14	13	40	50			Quotation	
M10x1.5	16							

ℓ_1	D_{h7}	Catalog No. Type	D	L	U/Price			
					Qty1~299	300~499	500~1999	2000~4000
1.0	0	*2	6	8 10 15			Quotation	
				3				
1.5	0	*4	10	15 20			Quotation	
				4				

ℓ_1	ℓ_2	Catalog No. Type	D	L	U/Price			
					Qty1~299	300~499	500~1999	2000~4000
1.5	0.3	*6	5	10 15 20 25 30				
				6				
2.0	0.5	*8	6	10 15 20 25 30 35 40 50			Quotation	
				8				
2.5	0.5	*10	10	15 20 25 30 35 40 45 50 60 70 80			Quotation	
				12				
3.0	1.0	*15	13	20 30 40 50 60 70 80 100 120			Quotation	
				16				
3.0	1.5	*18	20	40 50 60 70 80 100 120 150			Quotation	
				20				

* $\ell_2=6$ is a reference value when D = 5. * Only when D = 6 and L = 10, $\ell_2=6$.



Order

Catalog No. L



Delivery

MS2 - 20

Printed in Red • Other Product

SGP Stock 3

Days

For area out of Singapore, please refer to P.i.

Depth of Air Vent

0.15

Since these products are finished by barrel finishing, this value is for reference only. Same depth is applied to all dimension D.

Subject item :MSTP
MST
MSTM
MSTH

Stocks Availability Subjected to Prior Sales.