

# PRECISION EJECTOR LEADER PINS

— INLAY TYPE —



Printed in Red

The quantity discount rate is also applicable to alteration cost.  
All price & lead time are to be quoted.

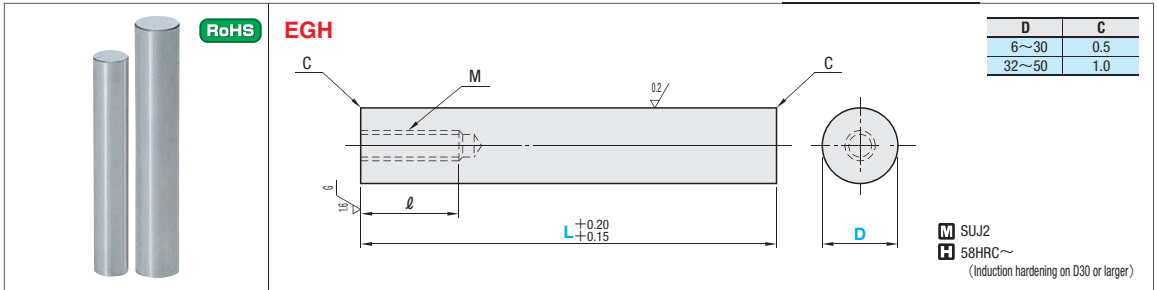

D	M	l	Part Number	L	Stock	U/Price			
	× Pitch		Type	5mm increments	L(mm)	1~9			
6	M4 × 0.7	8	EGH	6	30 ~ 70				
				8	30 ~ 70	50			
8	M5 × 0.8	10		10	30 ~ 70				
				12	30 ~ 70				
10	M6 × 1.0	12		13	30 ~ 70	80			
				16	40 ~ 70	50,60,70			
						13	75 ~ 100	80,90,100	
						16	105 ~ 125		
							130 ~ 150		
							40 ~ 70	60,70	
12	M8 × 1.25	16		20	75 ~ 100	80,90,100			
						25	105 ~ 125		
							130 ~ 150		
							40 ~ 70	60,70	
							75 ~ 90	80,90	
							95 ~ 110	100,110	
							115 ~ 130	120,130	
							135 ~ 150	150	
							155 ~ 175		
							50 ~ 70	80,90	
							75 ~ 90		
							95 ~ 110	100,110	
13	M10 × 1.5	20		25	115 ~ 130	120,130			
						30	135 ~ 150		
						155 ~ 170			
						175 ~ 200			
						205 ~ 225			
						230 ~ 250			
						255 ~ 275			
						280 ~ 300			
						50 ~ 70			
						75 ~ 90			
						95 ~ 110			
						115 ~ 130			
16	M10 × 1.5	20	32	135 ~ 150					
					30	155 ~ 170			
						175 ~ 200			
						205 ~ 225			
						230 ~ 250			
						255 ~ 275			
						280 ~ 300			
						50 ~ 70			
						75 ~ 90			
						95 ~ 110			
						115 ~ 130			
						135 ~ 150			
20	M10 × 1.5	20	32	155 ~ 170					
					30	175 ~ 200			
						205 ~ 225			
						230 ~ 250			
						255 ~ 275			
						280 ~ 300			
						50 ~ 70			
						75 ~ 90			
						95 ~ 110			
						115 ~ 130			
						135 ~ 150			
						155 ~ 170			
25	M10 × 1.5	20	32	175 ~ 200					
					30	205 ~ 225			
						230 ~ 250			
						255 ~ 275			
						280 ~ 300			
						50 ~ 70			
						75 ~ 90			
						95 ~ 110			
						115 ~ 130			
						135 ~ 150			
						155 ~ 170			
						175 ~ 200			
30	M10 × 1.5	20	32	205 ~ 225					
					30	230 ~ 250			
						255 ~ 275			
						280 ~ 300			
						50 ~ 70			
						75 ~ 90			
						95 ~ 110			
						115 ~ 130			
						135 ~ 150			
						155 ~ 170			
						175 ~ 200			
						205 ~ 225			
32	M10 × 1.5	20	32	230 ~ 250					
					30	255 ~ 275			
						280 ~ 300			
						50 ~ 70			
						75 ~ 90			
						95 ~ 110			
						115 ~ 130			
						135 ~ 150			
						155 ~ 170			
						175 ~ 200			
						205 ~ 225			
						230 ~ 250			

D	M	l	Part Number	L	U/Price	
	× Pitch		Type	5mm increments	1~9	
35	M10 × 1.5	20	EGH	35	50 ~ 70	
					75 ~ 90	
					95 ~ 110	
					115 ~ 130	
					135 ~ 150	
					155 ~ 170	
					175 ~ 200	
					205 ~ 225	
					230 ~ 250	
					255 ~ 275	
					280 ~ 300	
				40	M10 × 1.5	20
	75 ~ 90					
	95 ~ 110					
	115 ~ 130					
	135 ~ 150					
	155 ~ 170					
	175 ~ 200					
	205 ~ 225					
	230 ~ 250					
	255 ~ 275					
	280 ~ 300					
50	M10 × 1.5	20	EGH			
					75 ~ 90	
					95 ~ 110	
					115 ~ 130	
					135 ~ 150	
					155 ~ 170	
					175 ~ 200	
					205 ~ 225	
					230 ~ 250	
					255 ~ 275	
					280 ~ 300	

Quotation

Order  —   —   
 • Printed in Red • Printed in Blue

Delivery   Days

☎ For area out of Singapore please refer to P.I.

Quantity discount rate

Quantity	1~9	10~19	20~29	30~50
Rate	—	5%	10%	15%

Alterations  —  —   —  —



Example

Pin: Inlay type (with a tap)  
Bushing: Ball type

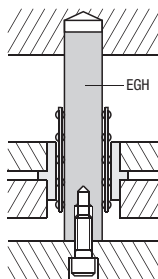

Alterations	Code	Spec.	Price
	LC	Changes the full length. LC=0.1mm increments Lmin.<LC<Lmax.	Quotation
	LKC	Changes the full length tolerance. L +0.20 ... L ≤ 200 ... +0.02 -0.15 ... 200 < L ≤ 350 ... +0.03 0	
	LKV	Changes the full length tolerance. L +0.20 ... +0.01 -0.15 ... 0 Not applicable to L > 150 ☎ Combining LC makes designation of LC0.01mm increments possible.	
	AVC	Air vent machining All D dimensions → Groove depth : 0.5±0.1 Groove width : 10±0.5	

☎ All pieces are ground together when 8 pieces or less are ordered for LKC · LKV (Although the tolerance of L dimension is as indicated, its dispersion is kept within a 0.01 range.)

Stocks Availability Subjected to Prior Sales.