

PULLER BOLTS

— FEMALE SCREW TYPE —



SGP Stock
Printed in Red

The volume discount rate is also applicable to alteration cost.
All price & lead time are to be quoted.

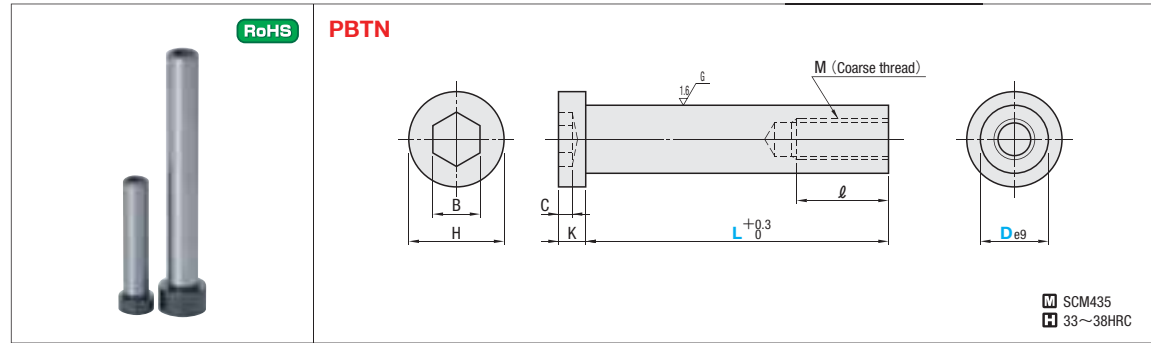

C	K	H	B	M	l	Catalog No.		U/Price
						Type	D	
4	8	16	6	6	17	10	40 50 60 70	
							80 90	
							100 110 120	
							130 140 150	
							160 170 180	
4	8	18	8	8	20	13	60 70	
							80 90	
							100 110 120	
							130 140 150	
							160 170 180	
7	13	24	10	10	23	16	190 200 210	
							220 230 240 250 260	
							280 300	
							100 110 120	
							130 140 150	
9	13	27	14	12	26	20	120 130 140 150	
							160 170 180	
							190 200 210	
							220 230 240 250 260	
							280 300	
10	18	33	17	16	32	25	170 180	
							190 200	
							210 220	
							230 240	
							250 260	

Order Catalog No. **PBTN13** — **L 110**

Delivery **Printed in Red** SGP Stock **3** Days **Printed in Blue**

Quantity discount rate

Quantity	1~9	10~19	20~49	50~100
Rate	—	5%	10%	15%

Alterations Catalog No. **PBTN20** — **LC205** **7** Days **Express B**

Alterations	Code	Spec.	Price		
	LC	L dimension alteration	D10-13 D16 D20 D25 Quotation		
		D		LC	
		10		35~175	
		13		55~275	
		16		95~295	
		20		115~395	
25	165~395				
	SC	Spanner groove alteration	D13 D16 D20 D25 Quotation		
		D		W	l ₁
		13		11	20
		16		14	
		20		18	

Available when D ≥ 13. Express services not available.

To control mold opening stroke by means of puller bolts alone, make sure to use puller bolt collars designed specially for them.

Reference item	Overview	Allowable range
Squareness of the shank part		Squareness of the head's internal plane against the vertical direction of shaft D. $a \leq 0.05$ per 100mm
Warpage of the shank part		Warpage of shaft D in L direction referring to the head's internal plane $c \leq 0.04$ per 100mm
D dimension and precision of end face		D and squareness of the end face 0.05 or less D and coaxiality of the tap 0.2 or less

PULLER BOLTS

— MALE SCREW TYPE(Enhanced) —



SGP Stock
Printed in Red

The volume discount rate is also applicable to alteration cost.
All price & lead time are to be quoted.

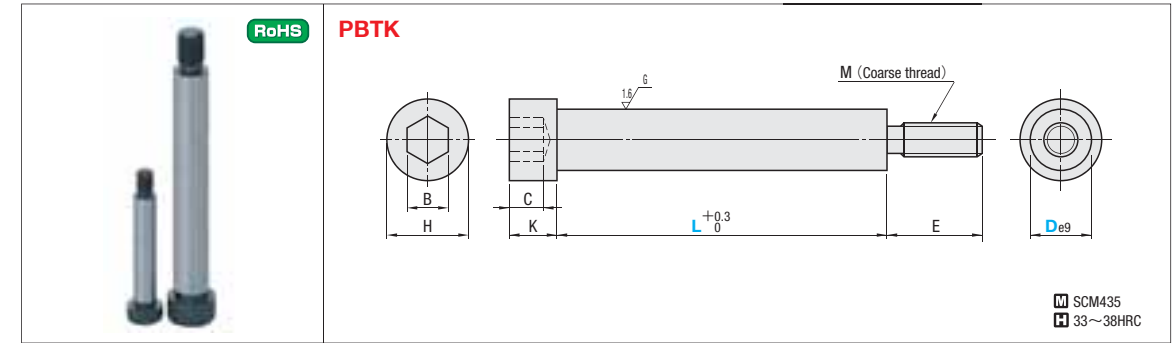

C	K	H	B	E	M	Catalog No.		U/Price
						Type	D	
4	8	16	6	19	M 8	10	100 110 120	
							130 140 150	
							160 170 180	
4	10	18	8	22	M10	13	100 110 120	
							130 140 150	
							160 170 180	
							190 200	
							210 220 230 240 260	
7	14	24	10	30	M12	16	100 110 120	
							130 140 150	
							160 170 180	
9	18	27	14	38	M16	20	190 200	
							210 220 230 240 250 260	
							280 300	
10	19	33	17	44	M20	25	140 150	
							160 170 180	
							190 200	
							210 220	
							230 240	

PBTK cannot be used in combination with PBTN.

Order Catalog No. **PBTK20** — **L 160**

Delivery **Printed in Red** SGP Stock **5** Days **Printed in Blue** **Express A**

Quantity discount rate

Quantity	1~9	10~19	20~49
Rate	—	5%	10%

For area out of Singapore please refer to P.I.

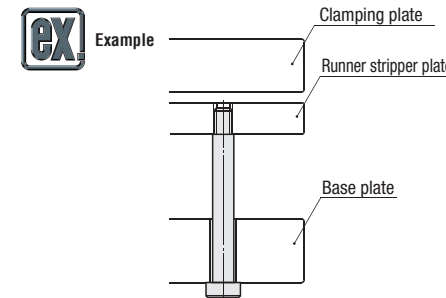

Characteristic
PBTK has a slightly greater head thickness and thread diameter than those of PBTK (previous product). This is to prevent the head and threaded part from becoming damaged.

M	D	10	13	16	20	25	
		PBTK	M8	M10	M12	M16	M20
K	D	PBTK	8	10	14	18	19
		PBTK	8	8	13	13	18