



Dear Valued Customer,

[Prior Notification]

Re: End of Sale Notification for Carbon Steel Miniature Linear Guide Products of MISUMI

Thank you for your order and your support. It is greatly appreciated. We wish you continued success and prosperity.

We would like to inform that we will stop the sale of these products below in 2021. Kindly consider switching to the replacement products. Should you need any further information, please feel free to contact us. Our apologies for the inconvenience caused.

1. End of Sale Product

Miniature Linear Guide Material: Carbon Steel, SEB, Others.

2. End Of Sale Date

on March 31, 2021.

3. Replacement Product

Miniature Linear Guide Material: Stainless Steel, SSEB, Others.

4. Modification in Specification of Replacement Product

There is no modification in Dimension of Product.

Modification in Material, from Carbon Steel to Stainless Steel (Equivalent to SUS440C), is the only change.

5. Contact

MISUMI South East Asia (Factory Automation – Industrial Components Team)

Technical Enquiries: E-Mail: techsupport@misumi.com.sg TEL: (65) 6733 7211

Sheet No.1

Material Modification, from Carbon Steel to Stainless Steel, of Miniature Linear Guides

Misumi Group Inc. has decided End of Sale date in 2021 for Carbon Steel-Miniature Linear Guides. Our apology for the inconvenience. We hope that you would consider switching to Stainless Steel Miniature Linear Guides. Please check the information below for Comparisons and Modification of Model Number.

1. Replacement Product – Modification in Specification

Material will be modified from Carbon Steel to Stainless Steel. There is no modification in Specification, Allowable Load Capacity, Allowable Moment, Standard Accuracy, and the others.

For instance: S(S)EB10-55 Example of Specification Comparison

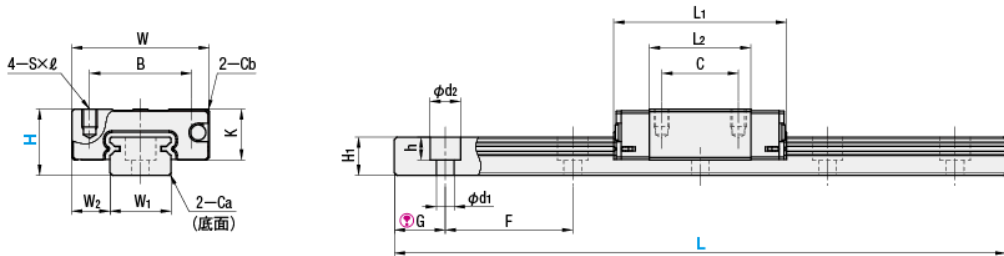

Dimension	W	L ₁	B	C	S×ℓ	L ₂	K	W ₁	W ₂	H ₁	d ₁ ×d ₂ ×h	F	G
Carbon Steel (SEB10-55)	20	30	15	10	M3×3	19	7.8	9	5.5	5.5	3.5×6×3.5	20	7.5
Stainless Steel (SSEB10-55)	20	30	15	10	M3×3	19	7.8	9	5.5	5.5	3.5×6×3.5	20	7.5

Allowable Load Capacity and Allowable Moment	Basic Load Capacity		Allowable Static Moment		
	C (Dynamic) kN	Co (Static) kN	M _A N·m	M _B N·m	M _C N·m
Carbon Steel (SEB10-55)	1.5	2.5	5.1	5.1	10.2
Stainless Steel (SSEB10-55)	1.5	2.5	5.1	5.1	10.2

2. Modification in Model Number of Replacement Product

In order to modify Model No. to Stainless Steel Product, please add a [S] to the top of Carbon Steel Products model No. For Low temperature black chrome plating product, please add a [S] next to [R].

(1) Normal product

[Carbon Steel] S E B 10 - 55 ⇒ [Stainless Steel] S S E B 10 - 55

(2) Low temperature black chrome plating product

[Carbon steel] R E B 10 - 55 ⇒ [Stainless Steel] R S E B 10 - 55

Miniature Linear Guide carbon steel target list

Product name	Unit Height H (mm)	Type	
		Carbon Steel	Stainless Steel
Standard Block Miniature Linear Guide	6~20	SEB etc.	SSEB etc.
Long Block Miniature Linear Guide	6~20	SELB etc.	SSELB etc.
Short Block Miniature Linear Guide	8~16	SEBS etc.	SSEBS etc.
Wide Rail Standard Block Miniature Linear Guide	6.5~16	SEBW etc.	SSEBW etc.
Wide Rail Long Block Miniature Linear Guide	9~16	SELBW etc.	SSELBW etc.
Standard Block Miniature Linear Guide with Dowel Holes	8~20	SEBN etc.	SSEBN etc.
Long Block Miniature Linear Guide with Dowel Holes	8~20	SELBN etc.	SSELBN etc.
Short Block Miniature Linear Guide with Dowel Holes	8~16	SEBSN etc.	SSEBSN etc.
Wide Block Miniature Linear Guide	8~20	SEBM etc.	SSEBM etc.
Wide Long Block Miniature Linear Guide	8~20	SELBM etc.	SSELBM etc.
Extra Long Block Miniature Linear Guide	8~16	SECB etc.	SSECB etc.
Wide Rail Standard Block Miniature Linear Guide with Dowel Holes	9~16	SEBWN etc.	SSEBWN etc.
Wide Rail Long Block Miniature Linear Guide with Dowel Holes	9~16	SELBWN etc.	SSELBWN etc.
Wide Rail Wide Block Miniature Linear Guide	9~16	SEBWM etc.	SSEBWM etc.
Wide Rail Wide Block Miniature Linear Guide	9~16	SELBWM etc.	SSELBWM etc.
Standard and Wide Block Miniature Linear Guide - Dust Resistant	13~20	SEBD etc.	SSEBD etc.
Low Temperature Linear Guide - Black Chrome Plating	8~20	REB etc.	RSEB etc.