

Metal Rollers

-Straight Crown Type / Female Thread Type / Bearing Type

CAD Data Folder Name: 16_Rollers

When ordering, select Part Number and Values from Selection Steps ①~④.

Ordering Example: Part Number (①Type-②D) - ③d - ④L
ROLB20 - **8** - **30**

■ Straight Crown Type **Configurable**

Type		Material	Surface Treatment
Straight	Crowned		
ROLB	-	S45C Equiv.	Black Oxide
ROLM	-	SUS304 Equiv.	Electroless Nickel Plating
ROLS	ROCS	SUS304 Equiv.	-
ROLA	ROCA	5000Series Alum Alloy	Clear Anodize

⑤ Machining conditions will be different depending on d dimension and L dimension. Refer to P.912 for details.

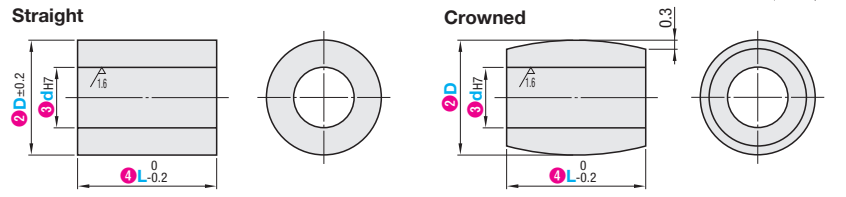

CAD 2D 3D RoHS

Part Number		③ dH7 Selection					④ L Selection							
① Type	② D													
Straight ROLB ROLM ROCS ROLA	Crowned ROCA	20	8				15	20	25	30	40	50		
		25	8	10	12		15	20	25	30	40	50		
		30	8	10	12	15		15	20	25	30	40	50	
		35	10	12	15	20		20	25	30	40	50		
	Straight ROLS	40		10	12	15	20		20	25	30	40	50	
		50			12	15	20	25		25	30	40	50	100
		60			12	15	20	25	30		30	40	50	100
		80			15	20	25	30		40	50	100		

■ Female Thread Type **Configurable**

Type		Material	Surface Treatment
Straight	Crowned		
ROLSN	ROCSN	SUS304 Equiv.	-
ROLAN	ROCAN	5000Series Alum Alloy	Clear Anodize

⑤ Machining conditions will be different depending on D dimension and L dimension. Refer to P.888 for details.

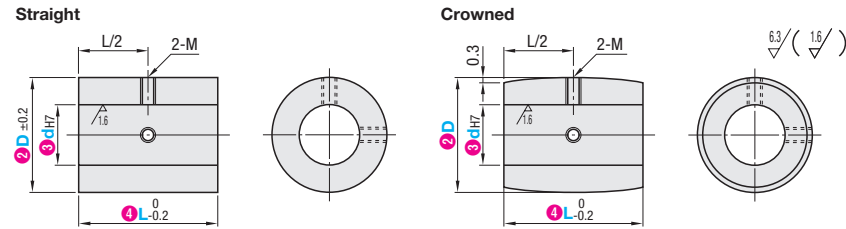

CAD 2D 3D RoHS

Part Number		③ dH7 Selection					④ L Selection					M			
① Type	② D														
Straight ROLSN ROLAN	Crowned ROCSN ROCAN	20	8				15	20	25	30	40	50	M3		
		25	8	10	12		15	20	25	30	40	50	M3		
		30	8	10	12	15		15	20	25	30	40	50	M3	
		35	10	12	15	20		20	25	30	40	50	M4		
	Straight ROLSN ROLAN	40		10	12	15	20		20	25	30	40	50	M4	
		50			12	15	20	25		25	30	40	50	100	M5
		60			12	15	20	25	30		30	40	50	100	M5
		80			15	20	25	30		40	50	100			

Days to Ship: **5** Days (Others: **7** Days) **Express B**

Order Quantity	Standard Service	Non-Standard Service
	Regular Quantity	Large Quantity
Quantity	1-30	31-50
Days to ship	Standard	To be quoted

When ordering, select Part Number and Values from Selection Steps ①~③.

Ordering Example: Part Number (①Type-②No.) - ③L
RORB30 - **30**

■ Bearing Type **Configurable**

Type		Material	Surface Treatment
Straight	Crowned		
RORB	ROCRB	S45C Equiv.	Black Oxide
RORM	ROCRM	SUS304 Equiv.	Electroless Nickel Plating
RORS	ROCRS	SUS304 Equiv.	-
RORA	ROORA	5000Series Alum Alloy	Clear Anodize

⑤ For bearing detailed dimensions, refer to P.655 and 657.

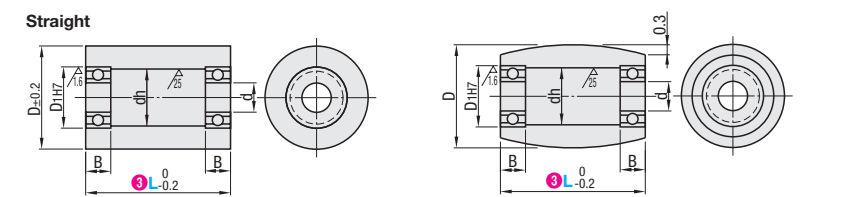

CAD 2D 3D RoHS

Part Number		D	③ L Selection										d	D _{1(H7)}	dh	B	Bearing		
① Type	② No.																		
Straight RORB RORM RORS RORA	Crowned ROCRB ROCRM ROCRS ROORA	20	15	20	25	30	40	50							6	15	10	5	696ZZx2
		25	20	25	30	40	50	60	70	80	90	100			6	15	10	5	696ZZx2
		30	20	25	30	40	50	60	70	80	90	100			8	19	15	6	698ZZx2
		35A	25	30	40	50									8	22	15	7	608ZZx2
		35	25	30	40	50	60	70	80	90	100				10	22	18	6	6900ZZx2
	Straight RORB RORM RORS RORA	40A	25	30	40	50									10	26	18	8	6000ZZx2
		40	25	30	40	50	60	70	80	90	100				12	28	24	8	6001ZZx2
		50A	25	30	40	50									12	32	24	10	6201ZZx2
		50	25	30	40	50	60	70	80	90	100				15	32	28	9	6002ZZx2

Days to Ship: **5** Days (Others: **7** Days) **Express B**

Order Quantity	Standard Service	Non-Standard Service
	Regular Quantity	Large Quantity
Quantity	1-30	31-50
Days to ship	Standard	To be quoted

⑤ Machining Conditions of Round Hole Type and Set Screw Type

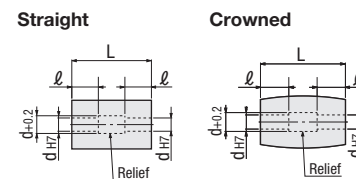

■ L Dimension

d	Overall Length						L Dimension
	15	20	25	30	40	50	
8	No Relief			8	8	16	16
10	No Relief			10	10	10	-
12	No Relief			12	24	24	
15	No Relief				15	30	
20	No Relief					40	
25	No Relief					25	
30	No Relief					30	

⑤ When L<dx3, straight (no relief).
 When L>dx3, effective length of both sides dx1(l), others with relief.
 When L>dx4, effective length of both sides dx2(l), others with relief.
 * There may be no relief in some cases.

Urethane, Rubber Lined Rollers

-Straight Type-

Urethane and Silicon Rubber are baked on the outer circumference of the core material.

CAD Data Folder Name: 16_Rollers

When ordering, select Part Number and Values from Selection Steps ①~④.

Ordering Example: Part Number (①Type-②D) - ③d - ④L
 ROUS20 - 8 - 30

Configurable

Type	Material Core	Surface Treatment [Lining]	Hardness
ROUS	SUS304 Equiv.	Urethane (Natural Color)	Shore A90
ROUA	5000series Alum.Alloy		Shore A90
ROGS	SUS304 Equiv.		Shore A70
ROGA	5000series Alum.Alloy		Shore A70
ROHS	SUS304 Equiv.		Shore A50
ROHA	5000series Alum.Alloy		Shore A50
ROHA	5000series Alum.Alloy	Antistatic Urethane (Gray)	Shore A90
ROMA	5000series Alum.Alloy	Antistatic Urethane (Gray)	Shore A90
ROSA	5000series Alum.Alloy	Silicon Rubber (Light Gray)	Shore A70
ROSA	5000series Alum.Alloy	Silicon Rubber (Light Gray)	Shore A70

① When $L \leq dx3$, hole d is machined from the same direction.
 ② When $L > dx3$, hole d is machined from both ends as shown above. There may be no relief in some cases.

Part Number	②D	③dH7 Selection	④L Selection
ROUS UrethaneA90/SUS304	20	8	15 20 25 30 40 50
ROUA UrethaneA90/A5052	25	8 10 12	15 20 25 30 40 50
ROGS UrethaneA70/SUS304	30	8 10 12 15	15 20 25 30 40 50
ROGA UrethaneA70/A5052	35	10 12 15 20	20 25 30 40 50
ROHS UrethaneA50/SUS304	40	10 12 15 20	20 25 30 40 50
ROHA UrethaneA50/A5052	50	12 15 20 25	25 30 40 50 100
ROMA Antistatic UrethaneA90/A5052	60	12 15 20 25 30	30 40 50 100
ROSA Silicon RubberA70/A5052	80	15 20 25 30	40 50 100

① D60 and D80 are not available for ROSA.
 ② Urethane may discolor over time, but there is no effect on physical properties.

Days to Ship: **Urethane** 5 Days, **ROSA(Silicon Rubber)** 7 Days

Order Quantity	Standard Service Regular Quantity	Non-Standard Service Large Quantity
Quantity	1~50	51~
Days to ship	Standard	To be quoted

Urethane Lined Rollers

-Straight, Urethane Thickness Selectable Type-

Urethane Thickness Selectable

CAD Data Folder Name: 16_Rollers

When ordering, select Part Number and Values from Selection Steps ①~⑤.

Ordering Example: Part Number (①Type-②D) - ③d - ④L - ⑤T
 ROEUS60 - 20 - 50 - T5

Configurable

Type	Material Core	Lining	Hardness
ROEUS	SUS304 Equiv.	Urethane (Natural Color)	Shore A90
ROEUA	5000series Alum.Alloy		
ROEGS	SUS304 Equiv.		Shore A70
ROEGA	5000series Alum.Alloy		

① When $L \leq dx3$, hole d is machined from the same direction.
 ② When $L > dx3$, hole d is machined from both ends as shown above. There may be no relief in some cases.

Part Number	②D	③dH7 Selection	④L 10mm Increment	⑤T Selection
ROEUS UrethaneA90/SUS304	20	8	20~100	5
	25	8 10 12		
	30	8 10 12 15		
	35	8 10 12 15		
	40	8 10 12 15		
ROEUA UrethaneA90/A5052	40	8 10 12 15	30~100	5 10
	50	10 12 15 20		
	60	12 15 20 25		
	80	15 20 25 30		
ROEGS UrethaneA70/SUS304	50	10 12 15 20	30~100	5 10
	60	12 15 20 25		
ROEGA UrethaneA70/A5052	80	15 20 25 30	30~100	5 10
	100	20 25 30 40		

① Urethane may discolor over time, but there is no effect on physical properties.

Days to Ship: **7** Days, **Express B**

Order Quantity	Standard Service Regular Quantity	Non-Standard Service Large Quantity
Quantity	1~20	21~
Days to ship	Standard	To be quoted

EX Example

