

# Aluminum Hinges / Aluminum Hinges for Different Extrusion Sizes / Aluminum Hinges for Extra Low Head Cap Screw Type / Hinge Nuts

**Stock**  
**Reduced Production Time**

CAD Data Folder Name: 43\_Levers\_and\_Pulls

Ordering Example  
Part Number (Type-No.)  
**HHPSN5**  
**HHPSNT6**

## Aluminium Higes Aluminum Hinges for Different Extrusion Sizes



**HHPSN** (Clear Anodize)  
**HHPBSN** (Black Anodize)  
**HHPSF** (For Unequal Size Extrusions: Clear Anodize)

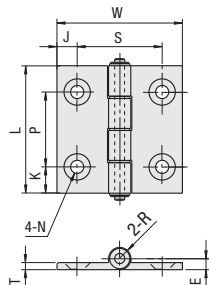

Material A6063S-T5 Bushing: Polyacetal  
Surface Treatment Anodize

Example  
For a set of screws and nuts for an aluminum extrusion, refer to P.1927.  
45 Sq. Extrusion 45 Sq. Extrusion 30 Sq. Extrusion 30 Sq. Extrusion

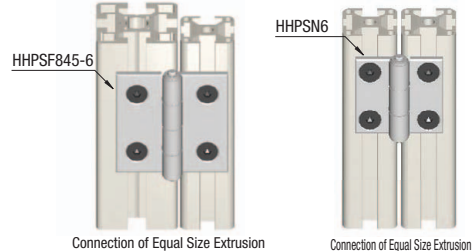

Connection of Equal Size Extrusion  
Connection of Equal Size Extrusion  
Hinges for Different Extrusion Sizes  
HHPSF 6-5: Mounts 20 SQ. (6mm W slot) extrusion on 30 SQ. extrusion (8mm W slot).  
HHPSF 8-6: Mounts 30 SQ. (8mm W slot) extrusion on 40 SQ. extrusion (10mm W slot).  
HHPSF845-5: Mounts 20 SQ. (6mm W slot) extrusion on 45 SQ. extrusion (10mm W slot).  
HHPSF 8-5: Mounts 20 SQ. (6mm W slot) extrusion on 40 SQ. extrusion (10mm W slot).  
HHPSF845-6: Mounts 30 SQ. (8mm W slot) extrusion on 45 SQ. extrusion (10mm W slot).  
The hinge nuts below are recommended when mating to panels, etc.

Part Number	Type	No.	*Allowable Load		Mass g	L	W	K	P	J	S	N		T	E	R	Days to Ship	
			kg	N								Through	Countersink				HHPSN	HHPBSN
HHPSN HHPBSN (Black Anodize)	5	10	98	22	47	36	11	25	7.5	21	5.5	11	3.5	5	5	Stock	Stock	
	6	10	98	33	48	8.5	30	8	32	6.5	13	3.5	5.5	5.5	Stock	Stock		
	8	10	98	48	62	13	37	10	42	6.5	13	3.5	5.5	5.5	Stock	Stock		
	8-45	15	147	81	63	80	10	43	16.5	47	6.5	13	3.5	5.5	5.5	Stock	Stock	

Part Number	Type	No.	*Allowable Load		Mass g	L	W	K	P	J	S	N		T	E	R	Days to Ship	
			kg	N								Through	Countersink				HHPSF	
HHPSF (For Different Extrusion Sizes)	6-5	10	98	33	47	44.75	8.5	30	10.75	26.5	5.5	11	3.5	5.5	5.5	Stock	Stock	
	8-5	10	98	43	63	54.25	13	37	15.25	31.5	5.5	11	3.5	5.5	5.5	Stock	Stock	
	845-5	10	98	43	63	55.5	13	37	14	34	5.5	11	3.5	5.5	5.5	3 Days	3 Days	
	8-6	15	147	48	63	62	13	37	12.5	37	6.5	13	3.5	5.5	5.5	Stock	Stock	
	845-6	15	147	48	63	62	13	37	11.5	39	6.5	13	3.5	5.5	5.5	Stock	Stock	

\*The allowable load is the value when 2 pieces are used. Stock lineup may vary by country. Stock: Same day shipping available upon request. Order by THA: 16:00, SGP: 12:00, MYS: 15:00 P.75

## Aluminum Hinges for Extra Low Head Cap Screw Type

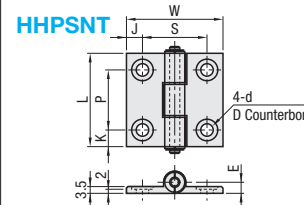

Material A6063 Bushing: Polyacetal  
Surface Treatment Clear Anodize

Example Normal cap screws can be used for installation.

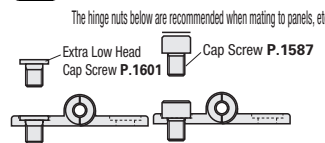

The hinge nuts below are recommended when mating to panels, etc.

Extra Low Head Cap Screw P.1601  
Cap Screw P.1587

Part Number	Type	No.	*Allowable Load		Mass (g)	L	W	K	P	J	S	d	D	E	Days to Ship	*HHPSN, HHPBSN, HHPSF		*HHPSNT	
			kg	N												Order Quantity	Standard Service Regular Quantity	Non-Standard Service Large Quantity	Order Quantity
HHPSNT	5	10	98	22	47	36	11	25	7.5	21	5.5	10	5	Stock	Standard	1-100	101~	Standard	201~
	6	10	98	34	48	8.5	30	8	32	6.5	11	5.5	5	Stock	Standard	1-100	101~	Standard	201~
	8	10	98	49	63	62	13	37	10	42	6.5	11	5.5	3 Days	Standard	To be quoted	To be quoted	Standard	To be quoted

\*The allowable load is the value when 2 pieces are used. Stock lineup may vary by country. Stock: Same day shipping available upon request. Order by THA: 16:00, SGP: 12:00, MYS: 15:00 P.75

When ordering, select Part Number and Values from Selection Steps 1-3.

Ordering Example  
Part Number (1) Type (2) No. (3) - (4) Number of Holes  
**HHPNT5** - **3**

## Hinge Nuts

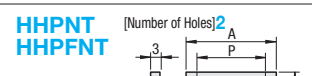

Material A6063 Bushing: Polyacetal  
Surface Treatment Clear Anodize

Part Number	Type	No.	Number of Holes	B	A	P	M	Days to Ship	Applicable Hinge Nuts for Panel Mounting	
									Hinges	No. of Applicable Hinge Nut
HHPNT	5	2	3	9	34	25	5	Stock	HHPSN HHPBSN	5
	6	2	3	10	40	30	6	Stock	HHPSJ SHPS SHPSNA	6
	8	2	3	10	40	30	6	Stock	HHPSNH HHPMS SHPSNA SHPSZ	8
	845	2	3	10	70	30	6	Stock	HHPSN HHPBSN HHPSJ SHPS SHPSNA SHPSNH HHPMS SHPSNA SHPSZ HHPNL HHPNR	8-45
	845	2	3	10	70	30	6	Stock	HHPSN HHPBSN HHPSJ SHPS SHPSNA SHPSNH HHPMS SHPSNA SHPSZ HHPNL HHPNR HHPFNT	8-45
HHPFNT	5	2	3	12	49	37	6	Stock	HHPSF	5
	6	2	3	12	86	37	6	Stock	HHPSF	6
	8	2	3	12	86	37	6	Stock	HHPSF	8
	845	2	3	12	55	43	6	Stock	SHPS	845
HHPFNT	5	2	14	33	20	5	7	Days	HHPFLN HHPFRN	5
	6	2	16	38	25	6	6	Days	HHPFLN HHPFRN	6
	8	2	18	48	30	6	6	Days	HHPFLN HHPFRN	8

Stock lineup may vary by country. Not applicable to HHPSJ6, SHPSNA6, SHPSZ6.  
Stock: Same day shipping available upon request.  
Order by THA: 16:00, SGP: 12:00, MYS: 15:00 P.75

# Aluminum Hinges Long Type-Short Type/Aluminum Hinges with Tabs

**Stock**  
**Reduced Production Time**

CAD Data Folder Name: 43\_Levers\_and\_Pulls

Ordering Example  
Part Number (Type-No.)  
**HHPSNC5**  
**HHPSNL6**  
**HHPSDT5**

## Aluminum Hinges - Short

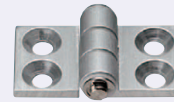

Short Type  
**HHPSNC**  
(Clear Anodize)  
**HHPBSNC**  
(Black Anodize)

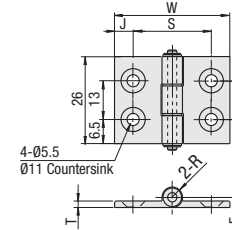

Material A6063S-T5 Bushing: Polyacetal  
Surface Treatment Anodize

Part Number	Type	No.	*Allowable Load		Mass g	W	J	S	T	E	R	Days to Ship	
			kg	N								HHPSNC	HHPBSNC
HHPSNC HHPBSNC (Black Anodize)	5	10	98	19	36	7.5	21	3.5	5	5	Stock	Stock	
	6	10	98	24	46	8	32	4.5	5.5	5.5	Stock	3 Days	
	8-45	15	147	36	27	62	10	42	4.5	5.5	5.5	3 Days	3 Days

\*The allowable load is the value when 2 pieces are used. Stock lineup may vary by country. Stock: Same day shipping available upon request. Order by THA: 16:00, SGP: 12:00, MYS: 15:00 P.75

## Aluminum Hinges - Long

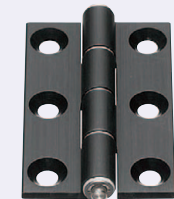

Long Type  
**HHPSNL**  
(Clear Anodize)  
**HHPBSNL**  
(Black Anodize)

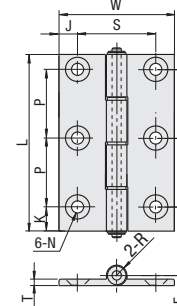

Material A6063S-T5 Bushing: Polyacetal  
Surface Treatment Anodize

Part Number	Type	No.	*Allowable Load		Mass g	L	W	K	P	J	S	N		T	E	R	Days to Ship	
			kg	N								Through	Countersink				HHPSNL	HHPBSNL
HHPSNL HHPBSNL (Black Anodize)	5	15	147	49	66	36	8	25	7.5	21	5.5	11	3.5	5	5	Stock	3 Days	
	6	15	147	69	78	48	9	30	8	32	6.5	13	3.5	5.5	5.5	Stock	Stock	
	8	15	147	106	113	62	13.5	43	10	42	6.5	13	3.5	5.5	5.5	Stock	Stock	
	8-45	23	220	144	113	62	13.5	43	10	42	6.5	13	3.5	5.5	5.5	Stock	Stock	

\*The allowable load is the value when 2 pieces are used. Stock lineup may vary by country. Stock: Same day shipping available upon request. Order by THA: 16:00, SGP: 12:00, MYS: 15:00 P.75

## Aluminum Hinges with Tabs



**HHPSDT**

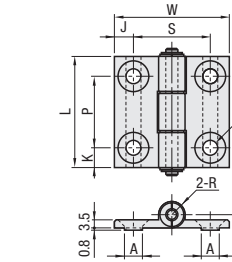

Material A6063 Bushing: Polyacetal  
Surface Treatment Clear Anodize

Example

The protrusions prevent misalignment, making mounting easy.

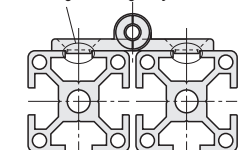

For a set of screws and nuts for an aluminum extrusion, refer to P. 1927.  
When mounting the hinge on a panel, Hinge Nuts included on P.2163 are recommended.

Part Number	Type	No.	*Allowable Load		Mass (g)	L	W	K	P	J	S	N		T	E	R	Days to Ship
			kg	N								Through	Countersink				
HHPSDT	5	10	98	23	47	36	11	25	7.5	21	5.5	11	5	5	5	5	Stock
	6	10	98	35	47	48	8.5	30	8	32	6.5	13	5	5	5.5	5.5	Stock
	8	10	98	51	63	62	13	37	10	42	6.5	13	5	5	5.5	5.5	Stock
	845	15	147	84	96	104	13	43	10	42	6.5	13	5	5	5.5	5.5	Stock

\*The allowable load is the value when 2 pieces are used. Stock lineup may vary by country. Stock: Same day shipping available upon request. Order by THA: 16:00, SGP: 12:00, MYS: 15:00 P.75

Order Quantity	Standard Service		Non-Standard Service	
	Regular Quantity	Large Quantity	Regular Quantity	Large Quantity
Quantity	1-200	201~	1-200	201~
Days to ship	Standard	To be quoted	Standard	To be quoted