

Long Nuts

-For HFS5 Series Aluminum Frames 20, 25, 40 Square-

Price Reduction
23%

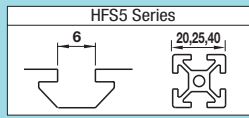

Nuts for Aluminum Frames / Pack

Price Reduction
23%

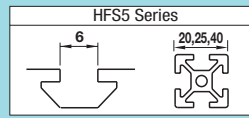

Tightening Torque **P676**

CAD Data Folder Name: 40_Aluminum_Frames

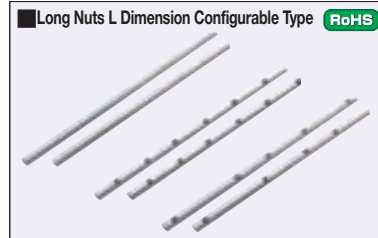

Type	Material	Surface Treatment	Reference Tightening Torque (N·m)
Pre-Assy. Insertion	S10C Equivalent	Trivalent Chromate	6.8
Post-Assy. Insertion	SUS303	-	

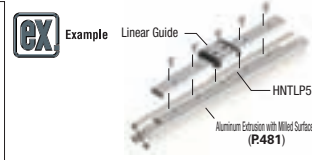

Cross Section Shape	A	B	E	T
Pre-Assy. Insertion	5.8	10	3.5	4.1
Post-Assy. Insertion	5.8	8	2.5	3.2

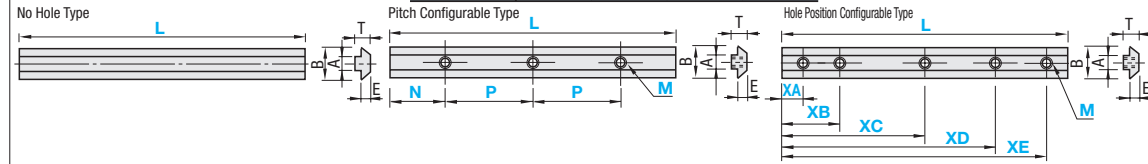

Part Number	L Specified in 1mm Increment	HNTLF5		SHNTLF5		HNTALF5	
		Unit Price	Unit Price/m	Unit Price	Unit Price/m	Unit Price	Unit Price/m
(Pre-Assy. Insertion) HNTLF5	50-2000	28	105	60	203	28	105
(Post-Assy. Insertion) SHNTLF5	50-1000						

Part Number	L Specified in 1mm Increment	M	N Specified in 1mm Increment	P Specified in 1mm Increment	Number of taps S	HNTLP5		SHNTLP5		HNTALP5		SHNTALP5	
						Unit Price	Unit Price/m	Unit Price	Unit Price/m	Unit Price	Unit Price/m	Unit Price	Unit Price/m
(Pre-Assy. Insertion) HNTLP5	3 4 5	5 ≤ N ≤ L-5	2M ≤ P ≤ L-2M	2 ≤ S ≤ 20	28	102	77	263	28	102	77	263	
(Post-Assy. Insertion) SHNTLP5													

Part Number	L Specified in 1mm Increment	M	XA-XE Specified in 1mm Increment	HNTLS5		SHNTLS5		HNTALS5		SHNTALS5	
				Unit Price	Unit Price/m	Unit Price	Unit Price/m	Unit Price	Unit Price/m	Unit Price	Unit Price/m
(Pre-Assy. Insertion) HNTLS5	50-2000	3 4 5	5-L-5	28	102	77	263	28	102	77	263
(Post-Assy. Insertion) SHNTLS5	50-1000										

Number of tapped holes can be specified between 1 to 5.

Part Number	L	M	N	P	S		
HNTLP5	200	M3	N10	P30	7		
HNTALP5	210	M5	N8	P15	8		
Part Number	L	M	XA	XB	XC	XD	XE
HNTLS5	1050	M5	XA20	XB105			
SHNTLS5	1050	M5	XA20	XB105	XC250	XD500	XE755
HNTALS5	1000	M5	XA25	XB85	XC78	XD975	XE92

Pitch Configurable Type	Unit Price / 1 Hole	Hole Position Configurable Type	Unit Price / 1 Hole
HNTLP5 / HNTALP5	88	HNTLS5 / HNTALS5	112
SHNTLP5 / SHNTALP5	133	SHNTLS5 / SHNTALS5	154

Delivery **7** Days Express **A** 230 Baht/piece **P88**
 Price **A** flat charge of 620 Baht for 3 or more identical pieces.

The prices of Pitch Configurable Type and Hole Position Configurable Type are found by adding the unit prices in the table to the hole machining charges.
 (Ex.) Part Number - L - M - XA - XB When
 HNTLS5 - 400 - M5 - XA10 - XB70
 (Unit Price/m x Specified OAL) + (Hole Machining Charge) = Sales Price
 102x0.4 + 112x2 = 264 Baht

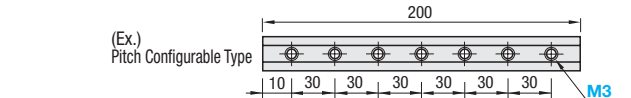

Long Nuts L Dimension Fixed Type



Type	Material	Surface Treatment	Reference Tightening Torque (N·m)
HNTK5	S10C Equivalent	Trivalent Chromate	6.8
HNTLG5	SUS303	-	-

Part Number	Unit Price		Volume Discount Rate
	1-499 pcs.	500-999	
HNTK5	109	105	98

Part Number	Unit Price		Volume Discount Rate
	1-499 pcs.	500-999	
HNTLG5	59	56	54
SHNTLG5 (Stainless Steel)	109	105	98

Order Example Part Number HNTLG5 Delivery **1** Day **P87**
 Alterations Part Number HNTLG5 - SET

Alteration	Code	Spec.	Type	Price Adder
Hexagon Socket Set Screw Set	SET	Hexagon socket set screws come as a set.	HNTLG5	18
		Type Set Screw Qty.	SHNTLG5	30
		HNTLG MSSK 4		
		SHNTLG MSSU 4		

CAD Data Folder Name: 40_Aluminum_Frames

Features: Bulk-packages are cost effective for in-house stock or large quantity uses.



Type	Body	Ball Springs	Material	Surface Treatment
PACK-HNTU	S10C Equivalent	SUS304	SWP-A	Trivalent Chromate

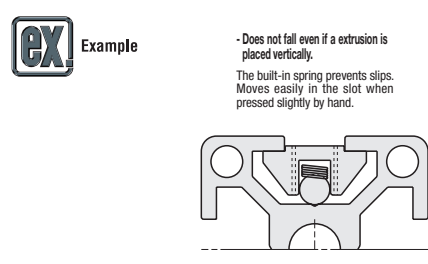

Part Number	Type	No.	M	Applicable Extrusion (Series)	A	B	E	T	L	L1	Unit Price (1-10 packages)	
											Package Price	Price per pc.
PACK-HNTU (100 pcs. per package)	5	3 4 5	HFS5	5.8	10	3.3	4.1	14	4.5	1,397	14	
	6	3 4 5 6	HFS6	7.8	15	6	6.8	16	5	1,456	15	
	8	4 5 6 8	HFS8 (-45)	9.8	17	6	9.0	18	6	1,635	17	



Type	Material	Surface Treatment
PACK-HNTT	S10C Equivalent	Trivalent Chromate



Part Number	Type	No.	M	Applicable Extrusion (Series)	A	B	E	T	L	L1	Unit Price (1-10 packages)	
											Package Price	Price per pc.
PACK-HNTT (100 pcs. per package)	5	3 4 5	HFS5	5.8	10	3.3	4.1	10	980	10		
	6	3 4 5 6	HFS6	7.8	15	5.5	6.3	14	1,012	11		
	8	4 5 6 8	HFS8 (-45)	9.8	17	6	9.0	17	1,159	12		

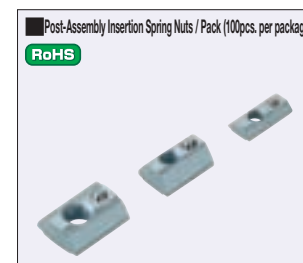

Type	Body	Ball Springs	Material	Surface Treatment
PACK-HNTP	S10C Equivalent	SUS304	SWP-A	Trivalent Chromate

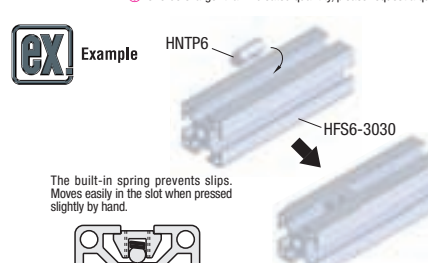

Part Number	Type	No.	M	Applicable Extrusion (Series)	A	B	E	T	L	L1	Unit Price (1-10 packages)	
											Package Price	Price per pc.
PACK-HNTP (100 pcs. per package)	5	3 4 5	HFS5	5.8	8.3	3.2	3.8	17	6	1,337	14	
	6	3 4 5 6	HFS6	7.8	11.5	6.3	6.8	17	6	1,397	14	
	8	4 5 6 8	HFS8 (-45)	9.8	14.5	6.3	7.0	20	8	1,547	16	



Type	Material	Surface Treatment
PACK-HNTA	S10C Equivalent	Trivalent Chromate

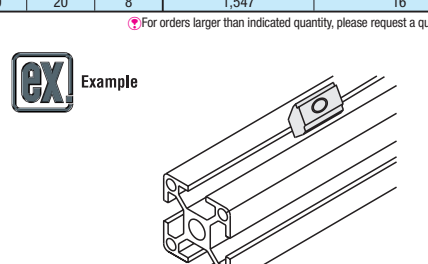

Part Number	Type	No.	M	Applicable Extrusion (Series)	A	B	E	T	L	L1	Unit Price (1-10 packages)	
											Package Price	Price per pc.
PACK-HNTA (100 pcs. per package)	5	3 4 5	HFS5	5.8	8.3	2.5	3.2	15	1,040	11		
	6	3 4 5 6	HFS6	7.8	11.5	5.5	6.3	17	1,012	11		
	8	4 5 6 8	HFS8 (-45)	9.8	14.5	4.5	6.5	20	1,099	11		

Order Example Part Number PACK-HNTA6 - 6 Delivery **1** Day **5** Days **P87**
 Stoppers are sold separately. **P503-546-584**

For orders larger than indicated quantity, please request a quotation.